

# US LETTER

Print the template on  
US Letter paper (220-270 g/m)

Pre-fold each dashed line with the  
blunt side of stanley knife blade

Cut all the black lines  
with the stanley knife

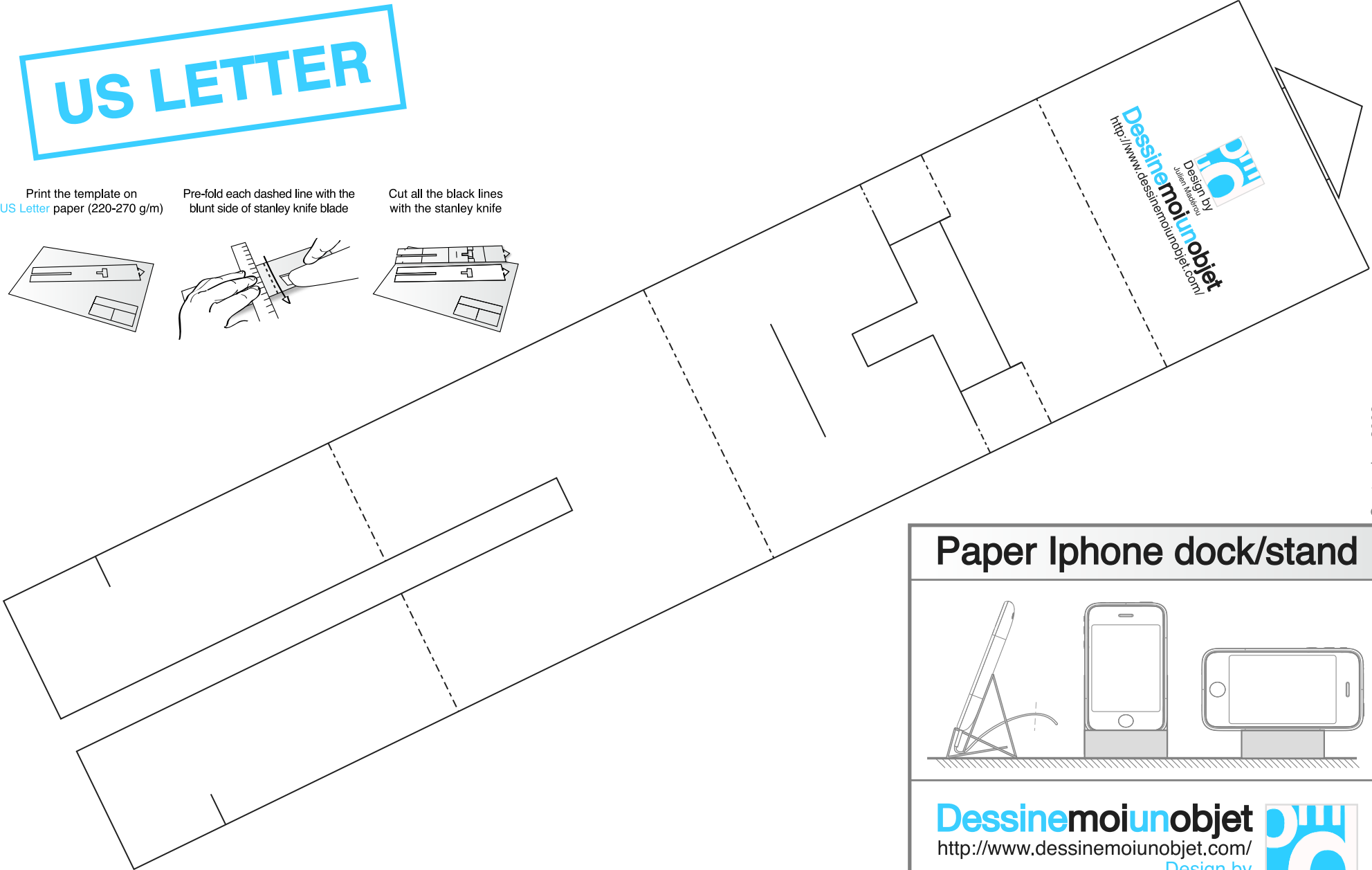
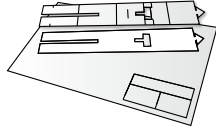
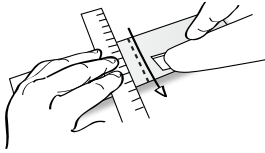
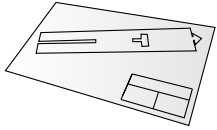

Fold and insert the  
tab in the slot

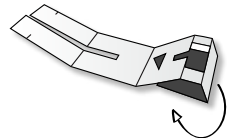

Fold and insert  
the two parts with the notches

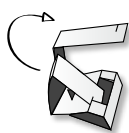

Press lightly  
to complete the shape

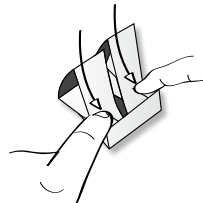

## Paper Iphone dock/stand

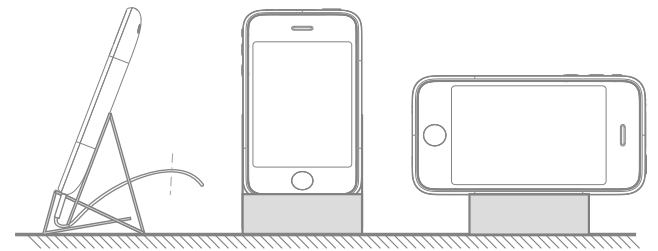

**Dessin moi un objet**  
<http://www.dessinmoiunobjet.com/>  
 Design by  
 Julien Mad  rou



— Cut —  
 - - - - - Fold - - - - -

**Use 270 g/m  
 cardpaper**

**Video :** <http://www.vimeo.com/6559478>